



Computer and Facility Considerations for Quintic Ball Roll Systems



Minimum Computer Specifications:

- Windows 11 / 10 64-bit Operating System. The system can't be used on earlier versions of Windows or 32bit machines
- Intel i7 Processor: 3rd Generation (Ivy Bridge or newer)
- 8GB RAM per camera required (16GB recommended)
- 500 GB free hard disk space to store video files
- Hard Drive Write Speed: Solid State Disk (SSD)
- 1 x USB3 (type A) port required per camera
- High Specification graphics capability
- Minimum Monitor Resolution: 1920 x 1080 or higher recommended
- Please note that the higher the computer specifications, the quicker the system will be able to process the video feed and data for each putt
- It is recommended to use the PC in 'High Performance'
- We also recommend that other applications are not running on the computer as this will slow down processing time
- We recommend that the PC is kept specifically for use with Quintic and no other camera capture software



Facility Specifications:

- A minimum putt distance of 8 feet is recommended (maximum ball speed 12mph)
- The System is positioned 1.77m from the ball. Please allow an extra 20cm for the back of the stand
- The USB3 High Speed Camera is powered directly from the computer. The connecting cable supplied is either 3m or 5m in length. Direct USB3 cables of up to 50m in length as well as extension cables are available to purchase separately. (Please note an extension cable will require a second USB port)
- The LED light will require mains power (either UK, EU or USA cable supplied with system). The connection cable for this is approximately 1.2m in length.
- We recommend the system is used on a level surface to begin with. Analysis on breaking putts or slopes is also possible with a more advanced set-up
- Certain artificial putting surfaces can cause the ball to bounce too high. We would recommend an indoor smooth putting surface on a solid base
- Overhead lighting should be evenly distributed where the system is measuring the putt
- Please note that external sunlight from a window in your facility that shines on the 20 inches measuring the putt may affect the ball brightness and the subsequent data. If this is a factor then window blinds to mask this sunlight are recommended
- The background behind the 20 inches of the putt should be clear from any type of reflections (metal, furniture etc.) If this is unavoidable then these reflections should be covered

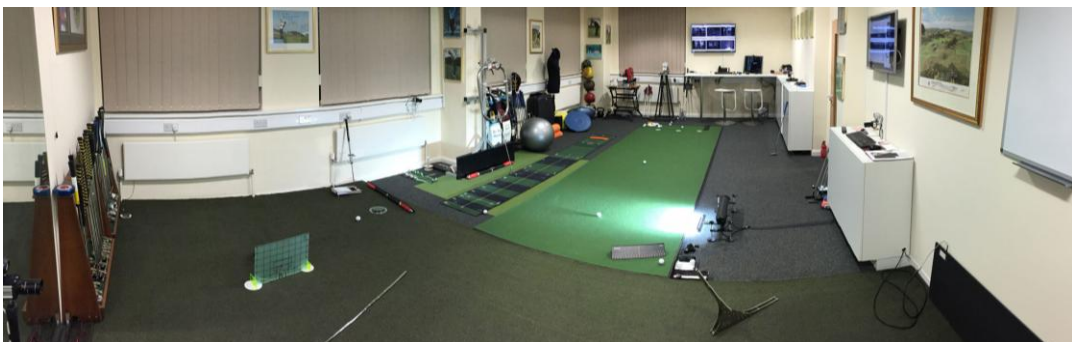



Accommodating for both Right & Left Handed Players



All Quintic Ball Roll Systems are designed to provide quick and accurate data for both left and right handed players. Nevertheless facility considerations must be made if you are hoping to quickly accommodate both left and right handed players.

Setup 1

6 metres or more

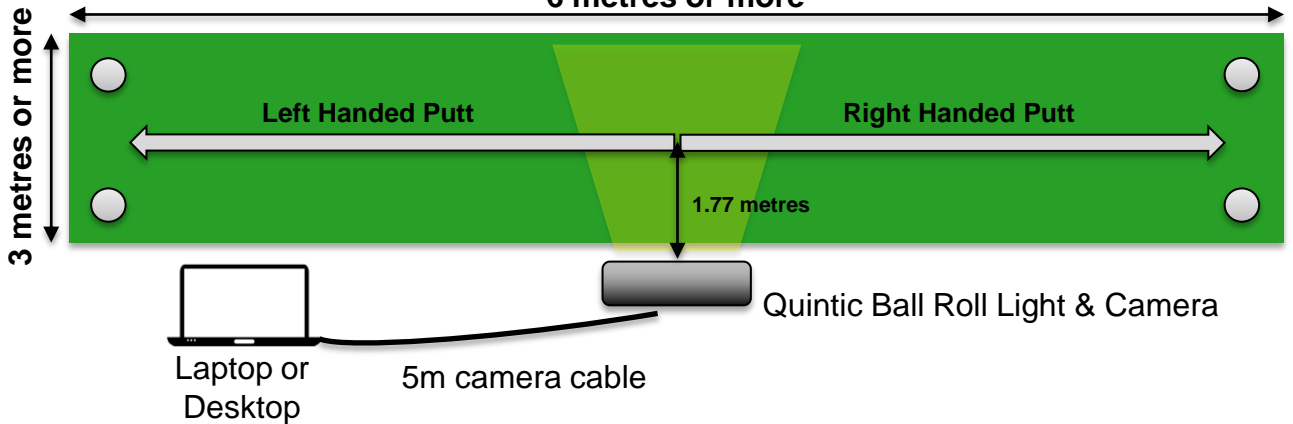

If your facility contains a putting green of 6 metres or longer then you can set up your Quintic Ball Roll System next to the centre of the green, allowing left handed players to simply putt in the opposite direction

Setup 2

4 metres

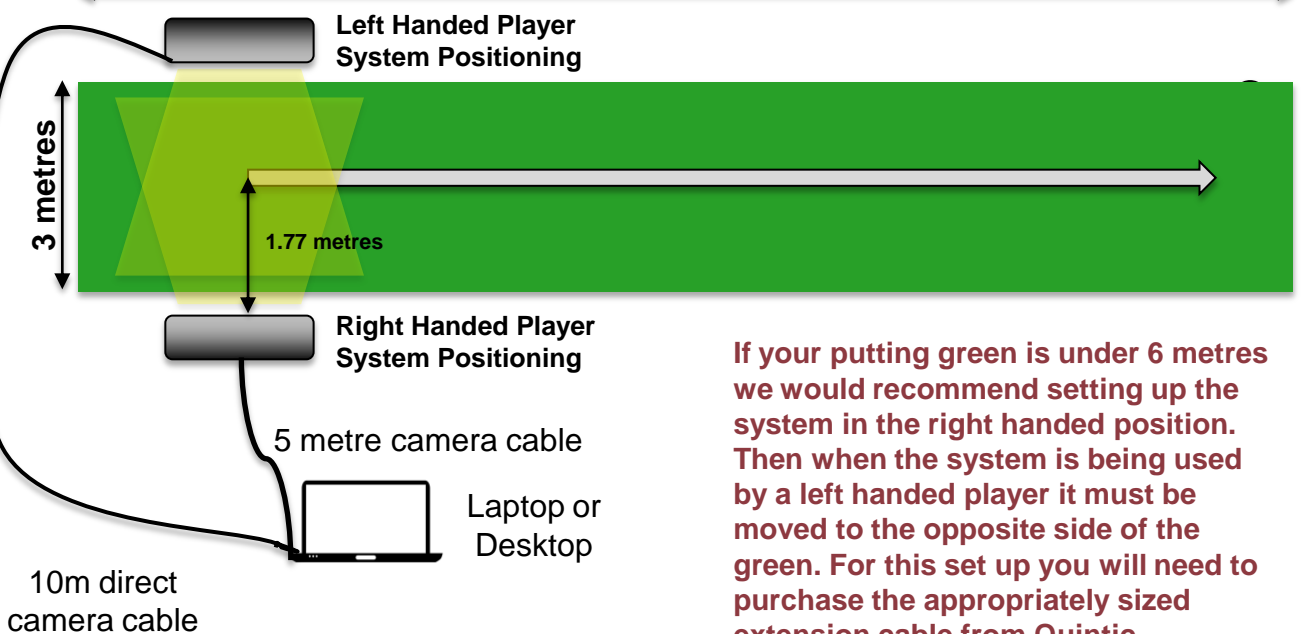

If your putting green is under 6 metres we would recommend setting up the system in the right handed position. Then when the system is being used by a left handed player it must be moved to the opposite side of the green. For this set up you will need to purchase the appropriately sized extension cable from Quintic.

For further information on facility requirements & set-up email: info@quintic.com